

## Lifting station Minilift F Free-standing set-up

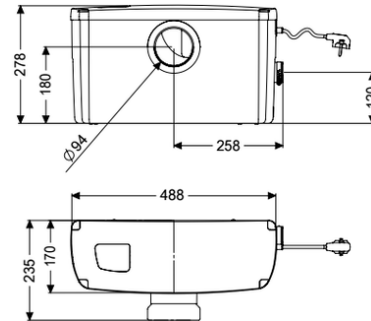

### Article information

Item no.: 28520  
GTIN: 4026092072899  
Price group: 20

### Advantages

- High-performance cutting unit SharkTwister
- Intelligent control technology
- Easy maintenance

### Description

The ready to plug in small lifting station for faecal and faecal-free wastewater is suitable for the wastewater drainage of individual toilets. The collection tank made of polymer (ABS) is equipped with a backflow preventer, an activated carbon filter, an alarm function, a horizontal inlet DN 100 and two horizontal inlets DN 40. The integrated control unit controls the small lifting station via pneumatic level measurement.

#### Variant

|                           |             |
|---------------------------|-------------|
| Type of system:           | Single unit |
| Backwater protection:     | integrated  |
| Pressure pipe connection: | horizontal  |

#### General characteristics

|                         |                            |
|-------------------------|----------------------------|
| Colour:                 | white                      |
| Standard:               | EN 12050-3                 |
| Type of wastewater:     | with sewage                |
| Installation situation: | free-standing installation |
| Delivery state:         | plug-in ready              |

#### Dimensions

|               |         |
|---------------|---------|
| Net weight:   | 7,33 kg |
| Gross weight: | 7,53 kg |
| Length:       | 488 mm  |
| Width:        | 237 mm  |
| Height:       | 285 mm  |

|   |                                  |
|---|----------------------------------|
| Packaging dimension:                                | length                           |
| Packaging dimension:                                | width                            |
| Packaging dimension:                                | height                           |
| Tank/drain body                                     |                                  |
| Pressure pipe connection (OD):                      | 28 mm                            |
| Distance from centre of outlet pipe to tank bottom: | 108 mm                           |
| Distance from centre of inlet pipe to tank bottom:  | 180 mm                           |
| Inlet nominal size (DN):                            | 110 mm                           |
| Inlet nominal size (DN):                            | 100 mm                           |
| Inlet type:   | 3                                |
| Pumping volume:                                     | 4 l                              |
| Tank volume:  | 11 l                             |
| Pumping device                                      |                                  |
| Number of pumps:                                    | 1                                |
| Connection type:                                    | Schuko (earthed contact) 2-pin   |
| Rated current:                                      | 2,8 A                            |
| Length of mains cable for pump:                     | 1,6 m                            |
| Self-diagnosis system (SDS):                        | I                                |
| Protection class control unit:                      | IP 44                            |
| DSC:  | integrated                       |
| Max. temperature (permanent) of conveyed material:  | 35 °C                            |
| Max. pumping height:                                | 6,4 m                            |
| Speed:  | 2900 U/min                       |
| Power P1:   | 0,65 kW                          |
| Power P2:   | 0,35 kW                          |
| Operating mode:                                     | S3 - 30 %                        |
| Type of pump connection cable:                      | H03 VV-F 3G 0.75 mm <sup>2</sup> |
| Impeller type:                                      | Macerator                        |
| Control   |                                  |
| Type of level measurement:                          | pneumatic                        |
| Operating voltage:                                  | 230 V                            |
| Connection type:                                    | Schuko (earthed contact) 2-pin   |
| Rated current:                                      | 2,8 A                            |